

Courses & Distances up  
Susquehanna River, Bog, at post

- N. 2. E. 38.
- N. 17 1/2. E. 18.
- N. 29. E. 22.
- N. 36. E. 10 to large rock  
88 perches

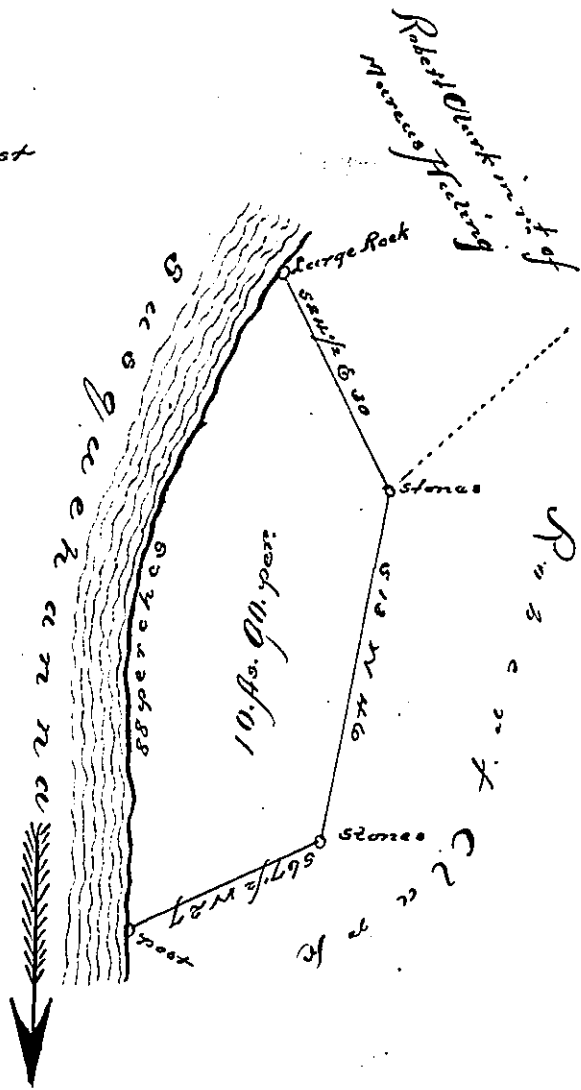

Surveyed the 10th day of October 1819 for Robert Clark, situate in Fairfax Township Dauphin County, containing ten Acres ninety perches and allowance of six per Cent by Warrant dated the 20th June 1804.

Thomas Smith D.S.

To Samuel Cochran Esquire  
Surveyor General of Pa

IN TESTIMONY that the above is a copy of the original remaining on file in the Department of Internal Affairs of Pennsylvania, made conformably to an Act of Assembly approved the 16th day of February, 1833, I have hereunto set my Hand and caused the Seal of said Department to be affixed at Harrisburg, this

second day of June, 1896.

James W. Patton  
Secretary of Internal Affairs.